

Carefully read the centrifuge instruction manual and the rotor instruction manual before using the rotor.

## S110AT Angle rotor

Max. speed	110,000 rpm
Max. R.C.F.	691,000 × g
Rotor nominal capacity	32.0mL = 8 × 4.0mL
k factor	15

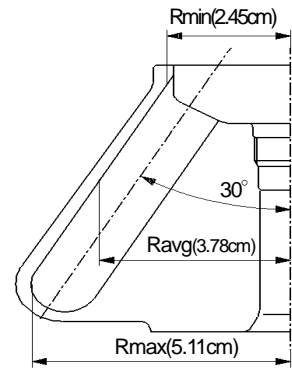

### (1) Summary of tubes

Tube				Space cap, Spacer or Crown		Maximum speed (rpm)	Maximum R.C.F. (× g)
Part No.	Name	Size (φ × L cm)	Net capacity (mL)	Part No.	Name		
S404332A	4 PC Tube	1.3×6.0	3.4	-----	-----	110,000	691,000
S303351A	4 PA Thick-walled tube	1.3×6.0	3.4	-----	-----	80,000	366,000
345319A	5 PA Seal tube	1.3×5.3	5.1	S404331	B4--Space cap	110,000	691,000
S308892A	Micro tube 1.5ml	1.09×4.0	1.3	-----	-----	48,000	103,000
84710901	Sampling tube 1.5ml	1.08×4.2	1.3	-----	-----	48,000	103,000
-----	1.5ml Micro tube	1.1×4.2	1.0	-----	-----	48,000	103,000
(S302893A)	(5 PA Re-seal tube)	1.3×5.1	5.1	(S405443A)	(Crown D2 ass'y)	110,000	691,000

Products in parentheses are those of the supply discontinuance.

### (2) Standard accessories

Part No.	Name	Q'ty
S404332A	4 PC Tube	2 (50pcs/box)
S402618	Cover packing	2
8062216	O-ring	2
452701	Tweezers	1
S203944	Cover opener 3	1
Common accessories of all rotors (see Appendix)		1

NOTE : When using Seal tubes or 1.5ml Micro tubes, the following optional accessories are required.

#### ● 5 PA Seal tube

- (a) 345319A 5 PA Seal tube..... 1(50pcs/box)
- (b) S404331 B4--Space cap..... 8
- (c) 901325 STF3 Tube sealer ..... 1
- (d) S201778A Tube rack (B)..... 1
- (e) S407157 Tube setter ..... 1

#### ● 1.5ml Micro tube

- (a) S406389 1.5 A5 Adapter..... 4

\*Use 1.5ml micro tube by four or less.

### (3) Separation characteristics table

Speed (rpm)	Max. R.C.F.(×g)			k factor
	Rmin (2.45cm)	Rav (3.78cm)	Rmax (5.11cm)	
10,000	2,740	4,230	5,710	1,862
20,000	11,000	16,900	22,900	466
30,000	24,700	38,000	51,400	207
40,000	43,800	67,600	91,400	116
50,000	68,500	106,000	143,000	74
60,000	98,600	152,000	206,000	52
70,000	134,000	207,000	280,000	38
80,000	175,000	270,000	366,000	29
90,000	222,000	342,000	463,000	23
100,000	274,000	423,000	571,000	19
110,000	331,000	511,000	691,000	15